

Initial Environmental Examination

PUBLIC

Document Stage: Addendum
Project Number: 51077-002
August 2024

Maldives: Greater Male Environmental Improvement and Waste Management Project

Outer Island Waste Management Improvements: Felidhoo, Vaavu Atoll

Prepared by the Ministry of Environment and Energy of the Republic of Maldives for the Asian Development Bank (ADB). This is an addendum of the document originally posted in April 2022 available on <https://www.adb.org/projects/documents/mld-51077-002-iee-1>

This addendum to the initial environmental examination is a document of the borrower. The views expressed herein do not necessarily represent those of ADB's Board of Directors, Management, or Staff, and may be preliminary in nature. Your attention is directed to the "terms of use" section of ADB's website.

In preparing any country program or strategy, financing any project, or by making any designation of or reference to a particular territory or geographic area in this document, ADB does not intend to make any judgments as to the legal or other status of any territory or area.

I. INTRODUCTION

1. The Greater Malé Environmental Improvement and Waste Management Project (GMEIWMP) will establish an integrated solid waste management system in Greater Malé and support Island Waste Management Centers (IWMCs) on 32 further inhabited islands in zone 3 which comprises the atolls of Alifu Alifu, Alifu Dhaalu, Kaafu, and Vaavu. Areas in which improvements will be introduced including collection, transfer, treatment using advanced waste-to-energy technology, disposal, recycling, dumpsite closure and remediation, and public awareness in reduce-reuse-recycle (3R), as well as institutional capacities for service delivery and environmental monitoring. The project will further improve climate change resilience and disaster risk management and contribute to reduced emissions into the environment.
2. The Initial Environment Examination (IEE) has been prepared for Felidhoo IWMC in April 2022. This addendum has been prepared due to a change in the dimensions of the site layout.

II. PROJECT DESCRIPTION

3. A detailed description of the project is provided in the IEE for the project (Chapter 4).
4. The project proposes to construct a new Integrated Solid Waste Management Centre (ISWMC) in Felidhoo Island. This centre will be used to manage the waste produced in the island before it is transferred to the regional waste management centre at Thilafushi.

A. Site Description

5. The IWMC site layout proposed in the IEE for Felidhoo has been revised. The new layout is shown in Figure 1 below. The proposed IWMC as indicated in the April 2022 IEE has a total area of 670.28 square meters. With the new layout, the total area of the IWMC will slightly decrease to 585.29 square meters. The IWMC will have the same components and dimensions as described in the April 2022 IEE.
6. Details of vegetation at the site have been included in the IEE. Additional vegetation removal will not be required as a result of the change in layout.

Figure 1: Proposed Site Layout

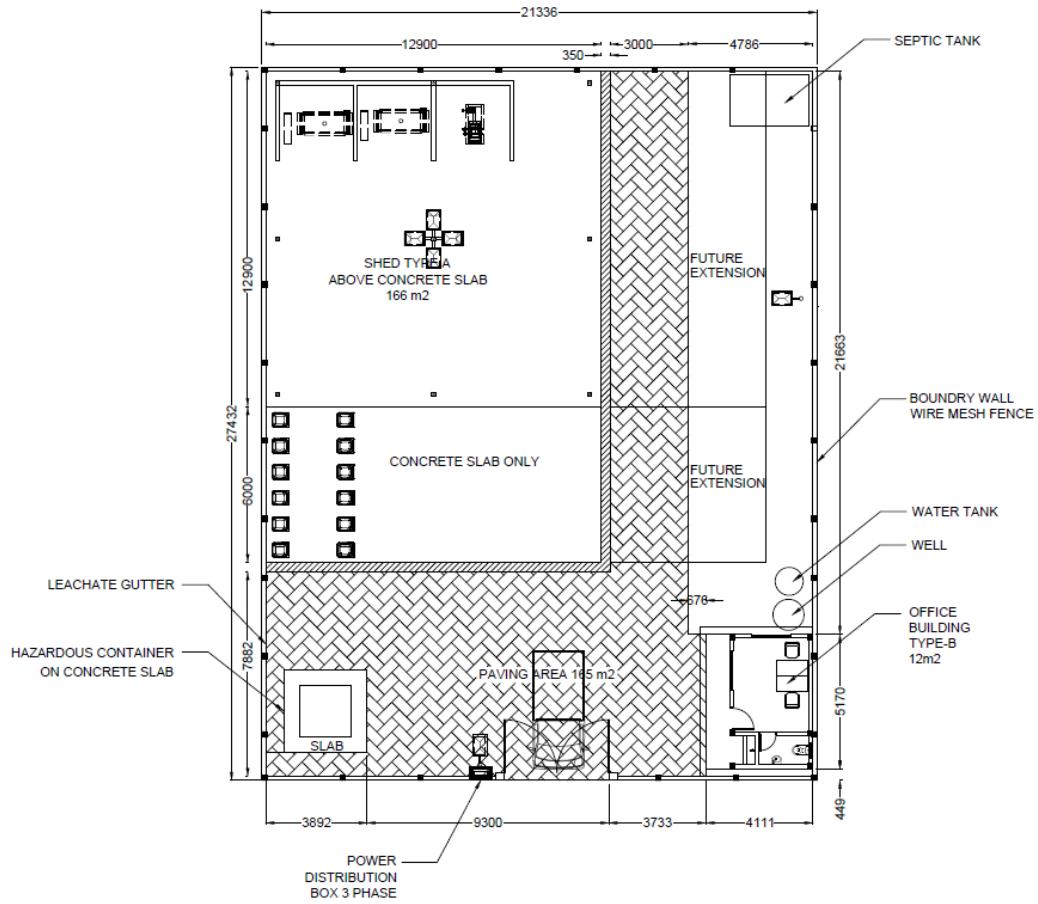

SITE LAYOUT - V. FELIDHOO
1:200

Figure 2: Proposed Site Location



III. ANTICIPATED ENVIRONMENTAL IMPACTS

7. A detailed description of anticipated Environmental Impacts and Mitigation Measures are provided in the 2022 draft IEE for the project (Chapter 7). No additional impacts are anticipated due to the change in layout.